

TERRASS - pergola

Fundamentering



Huvudkontor: Nola Industrier AB Box 17701 Repslagargatan 15b
 118 93 Stockholm T: 08 702 1960 F: 08 702 1962 headoffice@nola.se
 Kundtjänst/showroom/export/press: Skeppsbron 3 211 20 Malmö
 T: 040 171 190 F: 040 127 545 order@nola.se

www.nola.se

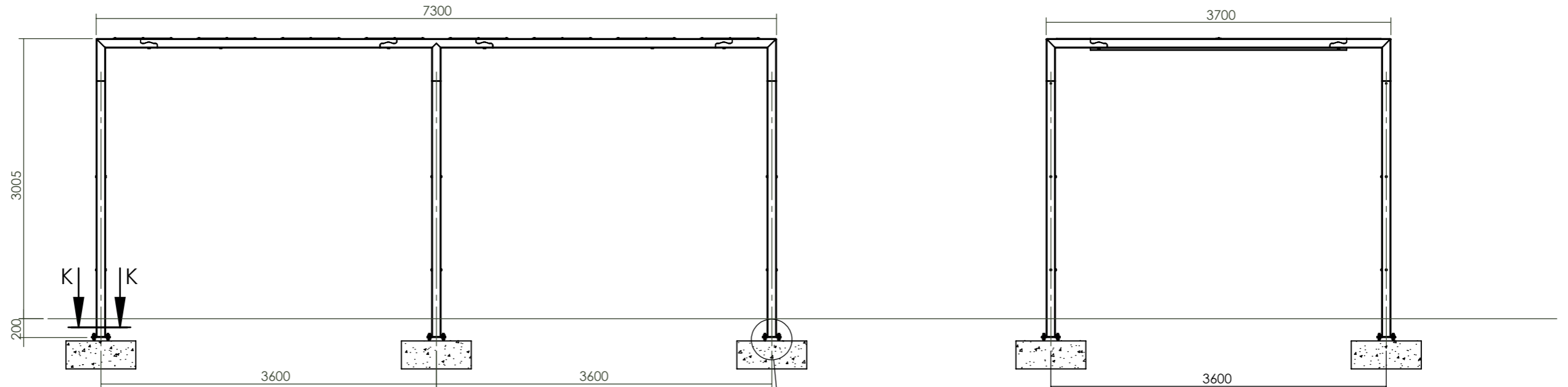

Foundation:

The pergola is equipped with foot plates that are bolted to a cast-in-place foundation approx. 200 mm below finished ground (can also be attached to foundations at ground level, resulting in a total height of 3250 mm). Suggested foundation method is to cast in cardboard tubes. In order for the meeting between the horizontal beams and post top to look good, it is important that the C-C dimensions are correct in all directions and that the pergola is mounted level. In order to accommodate certain deviations, the holes in the foot plate are oblong in one direction. The post is rotatable 90°, each post can therefore take up deviation either in depth or longitudinally, but not both at the same time. In cases where the ground is sloping, the depth of the foundation is adapted, remember that if trellis walls are used, the maximum depth of the bottom edge of the base plate is 250 mm below finished ground. . ATTENTION! For the installation to work, the foundations must always be level.

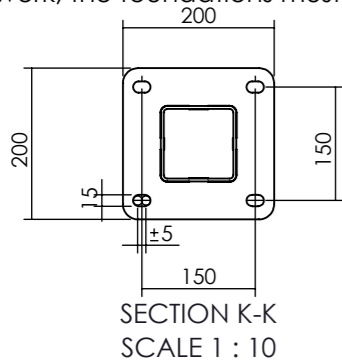

Dig to a frost-free depth and underfill with gravel or other draining material to avoid frost heaves. In cases where the pergola is placed on a cast slab or where the ground does not allow the foot plates to be buried, the foot plates are mounted at ground level. Adjusting nuts can be used under the foot plate to accommodate small level differences in the foundations. The holes in the foot plate are Ø15 mm for M12 anchorbolts / chemical anchors. /4 attachment points/post. As the foot plates end up under finished ground, all parts for fastening must be in A4 quality. Foundation anchor rods and nuts for mounting to the foundation are not included in the delivery

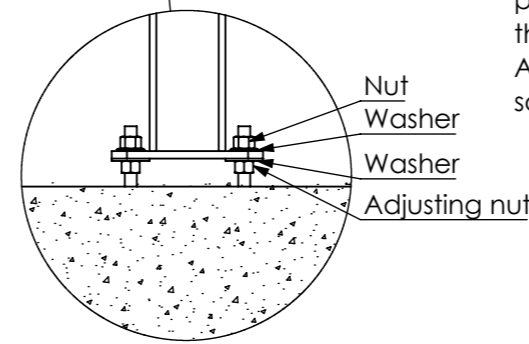

To be able to level the pergola, the foot plate is ideally first placed on adjusting nuts. By not tightening the upper nuts fully, the post can be adjusted as the horizontal beams are installed. Always check that the nuts are tightened before replacing the soil.

Since the design of the foundation is dependent on ground conditions on site, frost depth, water accumulation, etc. Nola cannot recommend a general weight or design for the foundations. If you have questions about the design of the foundations, contact the person responsible for ground work on site.

TERRASS - pergola

El-stolpe



Huvudkontor: Nola Industrier AB Box 17701 Repslagargatan 15b
118 93 Stockholm T: 08 702 1960 F: 08 702 1962 headoffice@nola.se
Kundtjänst/showroom/export/press: Skeppsbron 3 211 20 Malmö
T: 040 171 190 F: 040 127 545 order@nola.se

www.nola.se

Post with electrical opening can be ordered by adding "-EL" after the desired article number.

Ex. **U80-20EK/RM12-EL** = Terras pergola drawing template 12 with pergola modules in oak. One of the posts is equipped with electrical opening..

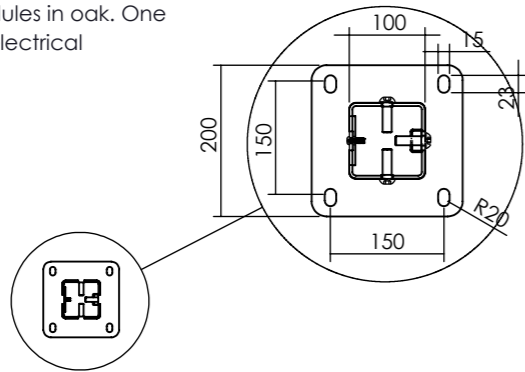

On delivery, the electrical opening is mounted with 2 pcs K6S security screw (torx) with round head) PIN, M6 x 16. A2

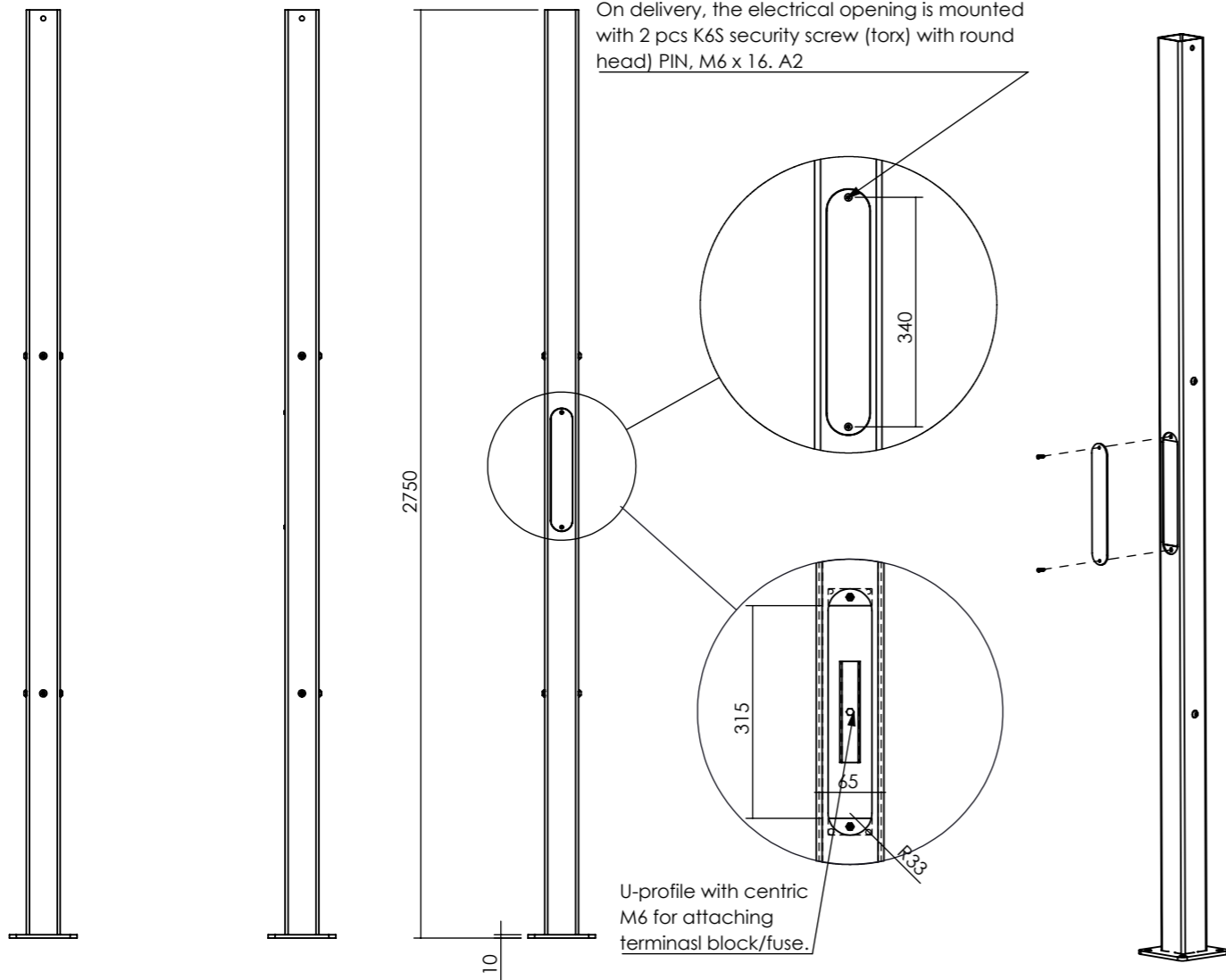

The post with electrical opening and the standard posts have the same hole pattern. This means that the post with electrical opening can replace any post in the pergola.

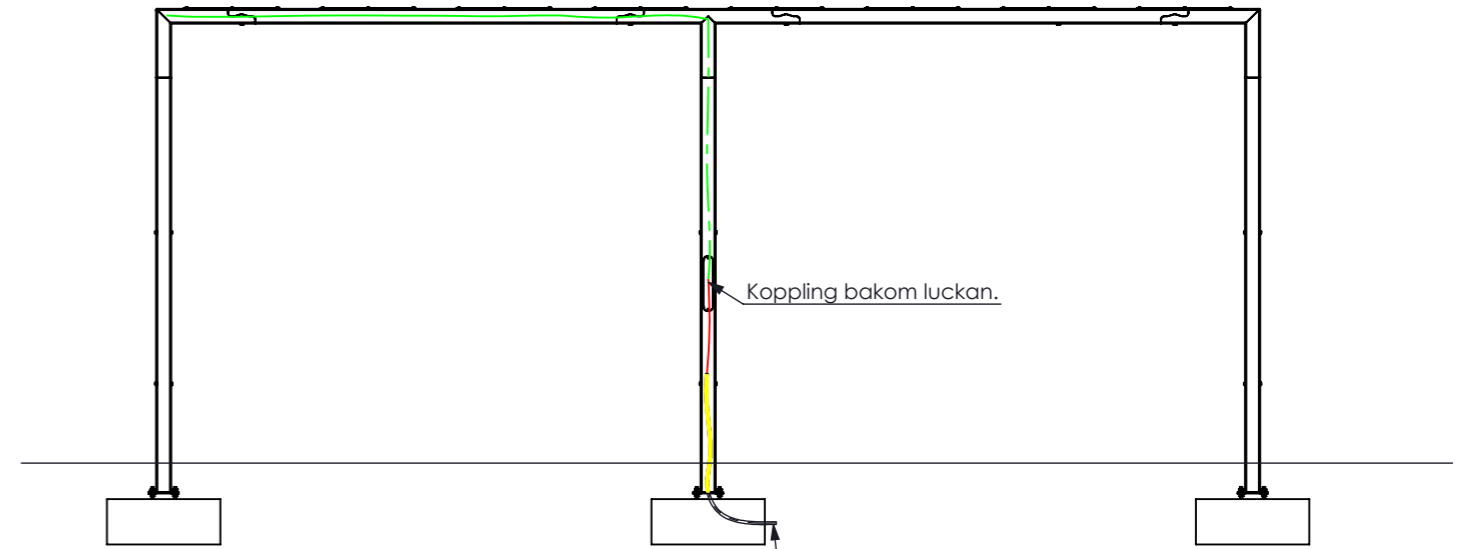

We suggest that electricity is pulled from the electrical cabinet, in approved conduit through the foundation and up in the center of the post. The connection is spliced behind the opening and pulled with pull string in the frame to the desired location.

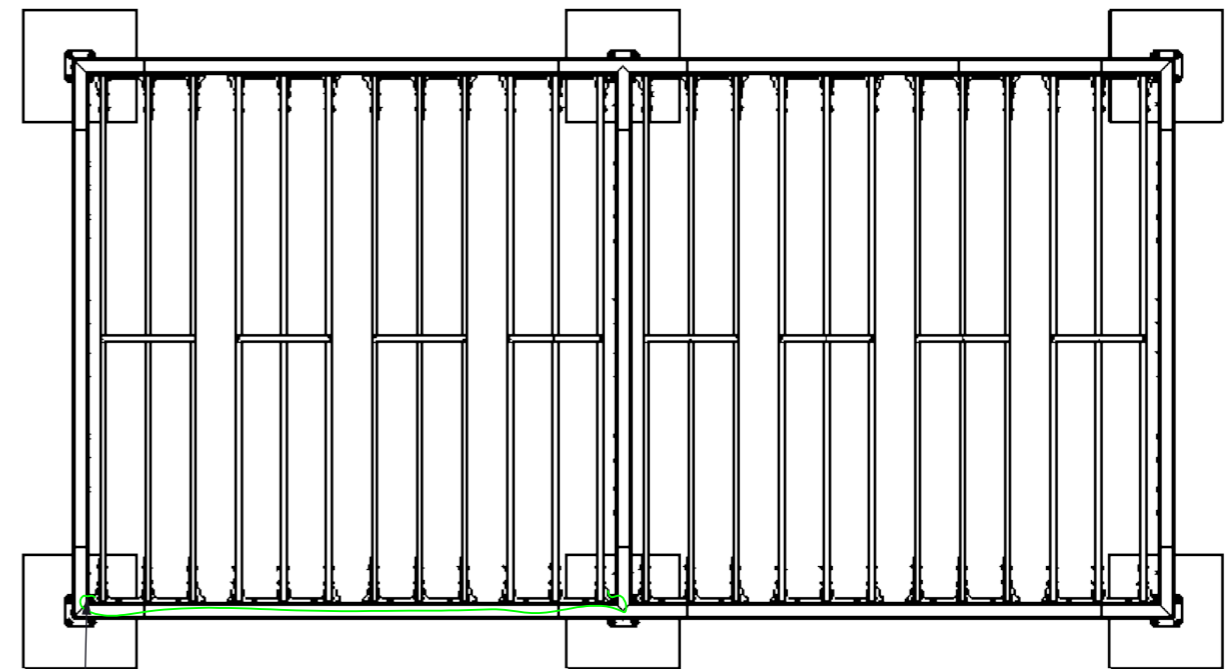

One of the screws (M12) not used to hold the roof can be unscrewed to allow the cable to exit. The cable can then be clamped against the oak crossbeams or the steel frame to reach the desired location. A threaded cable entry (M12) can be used where the cable passes through the pipe.



ATTENTION! Nola does not supply fixtures or other electrical equipment. Installation must always be done by a qualified electrician on site.

TERRASS - pergola

Montering ramverk



Huvudkontor: Nola Industrier AB Box 17701 Repslagargatan 15b
 118 93 Stockholm T: 08 702 1960 F: 08 702 1962 headoffice@nola.se
 Kundtjänst/showroom/export/press: Skeppsbron 3 211 20 Malmö
 T: 040 171 190 F: 040 127 545 order@nola.se

www.nola.se

Installation:

When delivered, the screws are installed in the top beams, post top and posts. This is because they must be painted in the same color as the other steel parts. Start by laying out the foundations. Then use the post as a template to get the hole pattern right. Drill the foundations and install in threaded rods. Then set the posts on the cross bars and tighten the nuts so the posts won't tip over but still allow some adjustment. Then start fitting the post tops to the posts. The post toppers are screwed to the post with 3 MK6S M12 x 40 (NOTE! The posts have screw holes on 3 sides for trellis installation. Remember to turn the post so that the trellises end up correctly in the next stage.

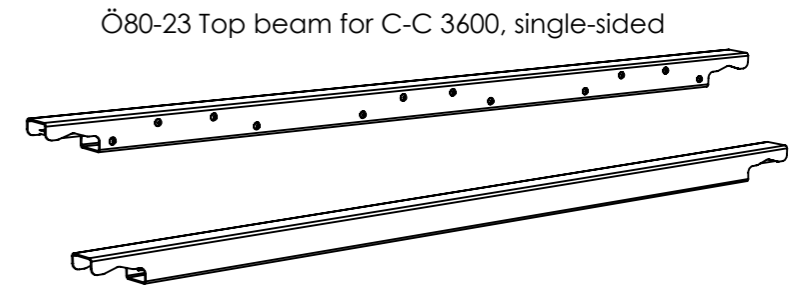
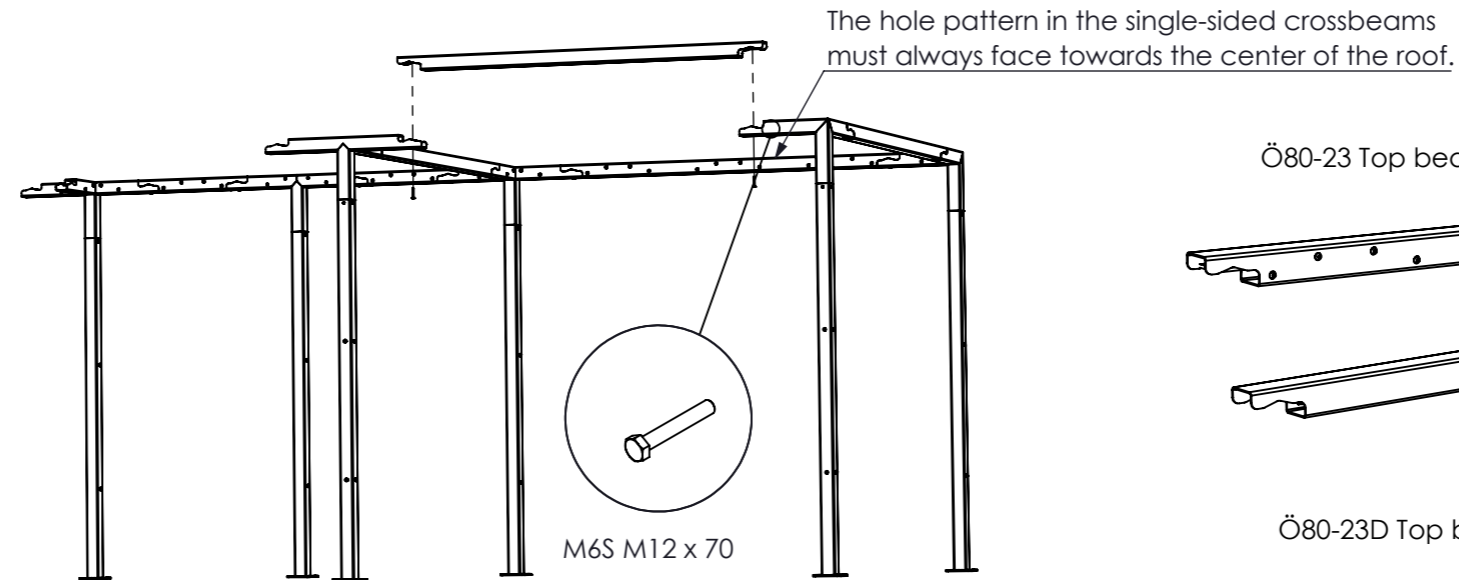

Ö80-23D Top beam for C-C 3600, double-sided

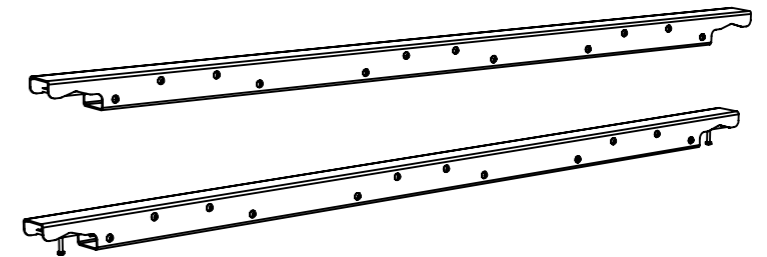

Fit the crossbeams between the post tops. It is suggested that a pipe is set up as soon as 2 post tops and posts are in place to stabilize the pergola. It is usually easiest to start in a corner. The crossbeams are mounted from the underside of the post top with two M6S M12 x 70 A2. (external 6-edge). As standard, the crossbeams have holes on one side for mounting pergola beams. In cases where 2 roofs are to be joined

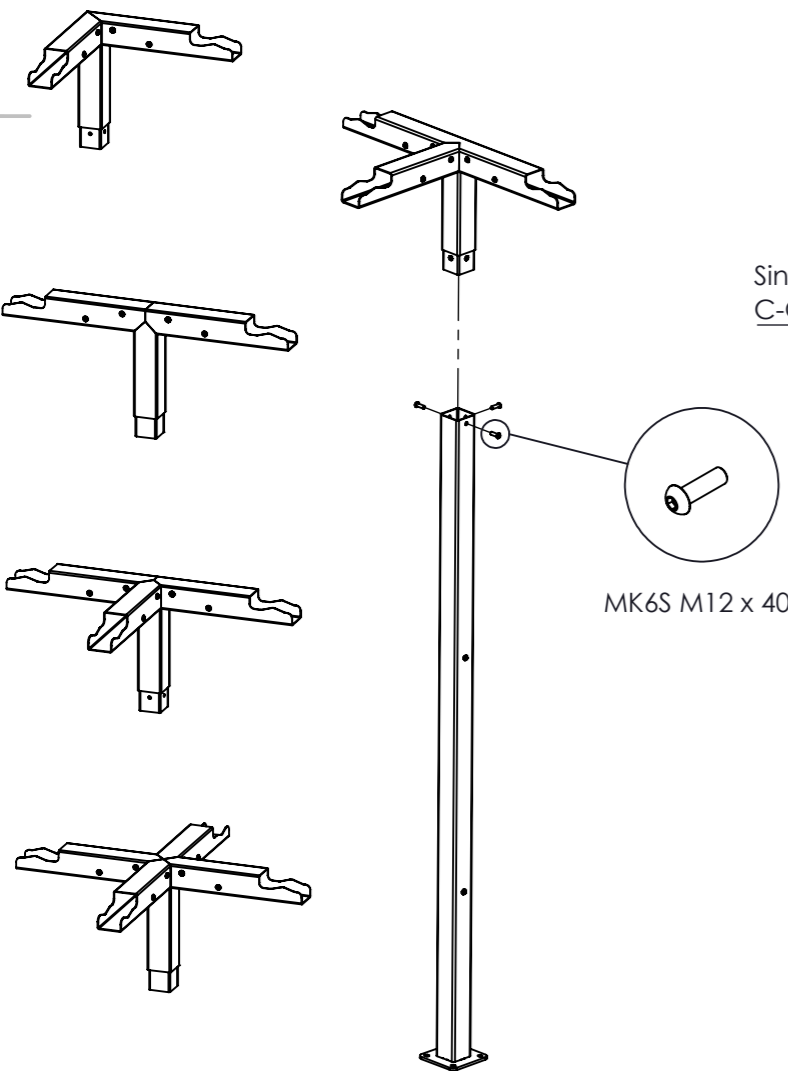

Single-sided top beam C-C 1800

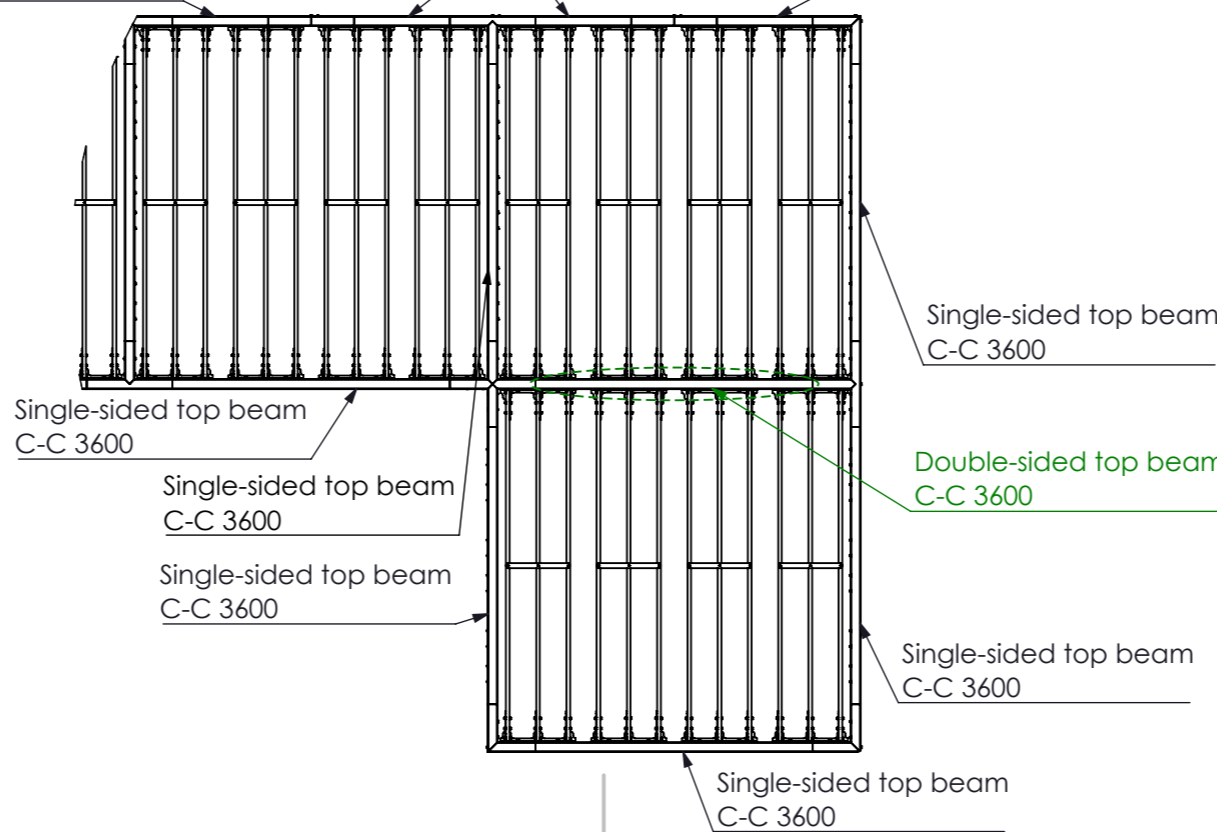

Ö80-24 Top beam for C-C 1800, single-sided

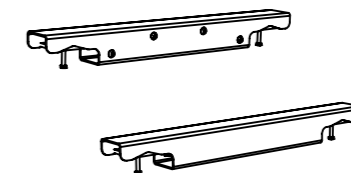

Ö80-24 Top beam for C-C 1800, double-sided

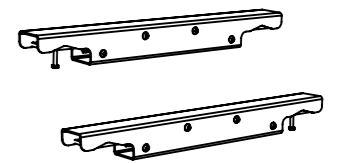

TERRASS - pergola

Montering pergolakassetter



Huvudkontor: Nola Industrier AB Box 17701 Repslagargatan 15b
118 93 Stockholm T: 08 702 1960 F: 08 702 1962 headoffice@nola.se
Kundtjänst/showroom/export/press: Skeppsbron 3 211 20 Malmö
T: 040 171 190 F: 040 127 545 order@nola.se

www.nola.se

Installation of pergola beams and screen walls:

The pergola beams are supplied as standard mounted in ceiling cassettes with 3 pergola beams in each.

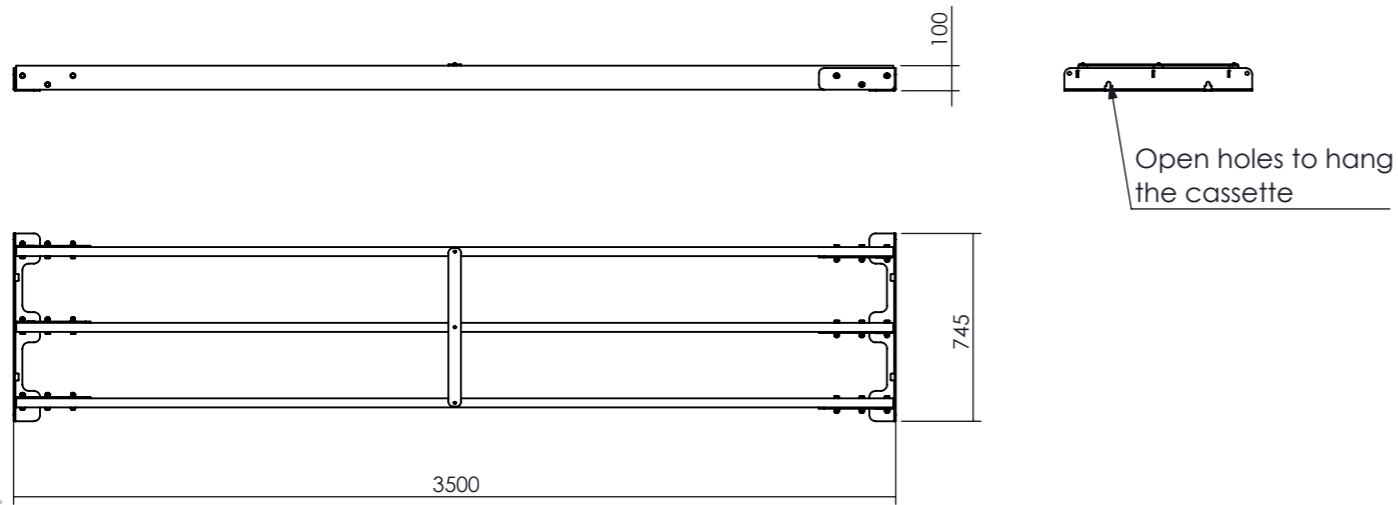

The holes in the sheet metal fittings are oblong. If necessary, some adjustment can be made by loosening all the screws and adjusting the plate fitting.

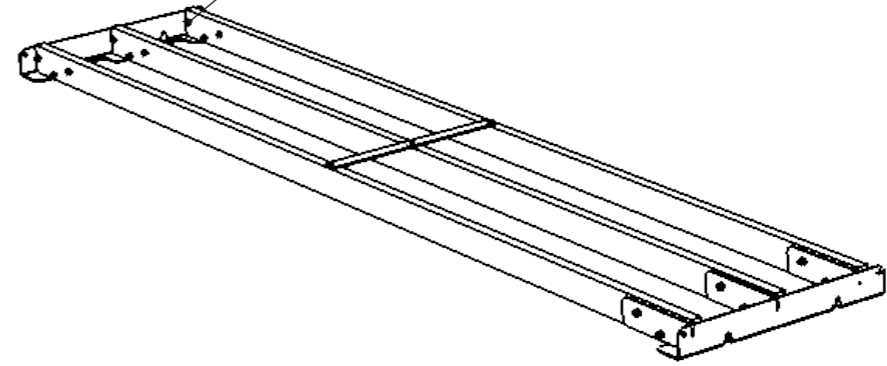

The screws for fixing the ceiling cassettes are installed in the top beam on delivery. Start by removing the top screws completely. Then unscrew the under screws approx. 10 mm. The lower holes in the ceiling cassette are open. Hang the ceiling cassette on the lower screws and then mount the upper screws.

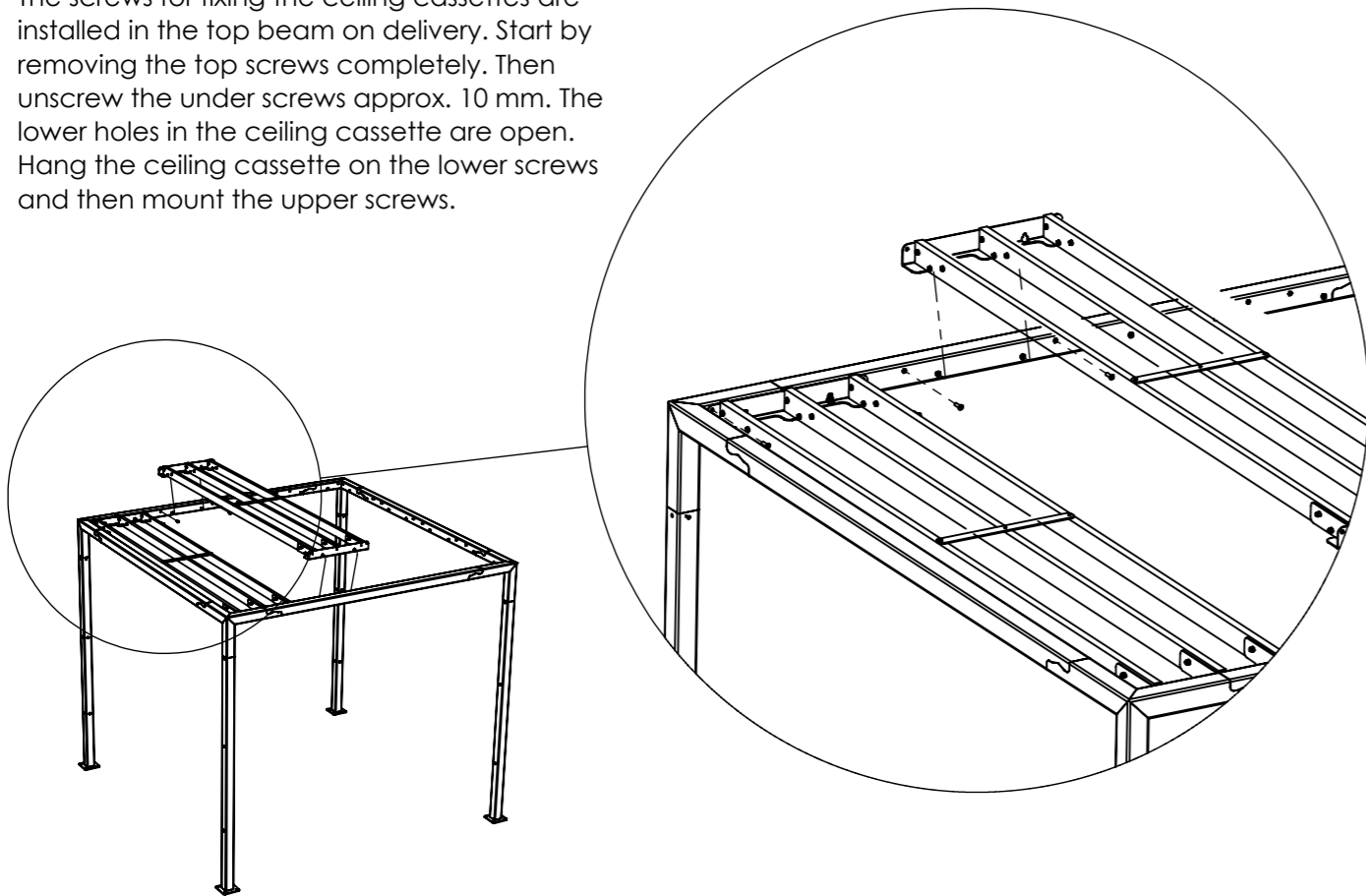

TERRASS - pergola

Montering av skärmväggar



Huvudkontor: Nola Industrier AB Box 17701 Repslagargatan 15b
118 93 Stockholm T: 08 702 1960 F: 08 702 1962 headoffice@nola.se
Kundtjänst/showroom/export/press: Skeppsbron 3 211 20 Malmö
T: 040 171 190 F: 040 127 545 order@nola.se

www.nola.se

Assembly of screen walls with angled boards:

The screen walls are delivered in parts and assembled together on site. Each cutting wall consists of 4 bent sheets, 27 oak ribs and 6 screws + washer. The screws for attaching the profiles are mounted in the post on delivery. Start by unscrewing the screws approx. 10 mm and thread on the outer profile right and left. Then screw the profiles. The profile must be turned with the smooth side of the outer profile outwards.

Then place the boards in the recesses of the profiles.

Upper hole when foot plate is placed at ground level

Lower track at foot plate 200 mm below ground

Finish by mounting the inner profile. The inner profile is mounted with 5 attached M6S M12 x 70 A2 + washer. The screws must be tightened until all pieces of wood are in the clamps. As the wood is a living material that moves with the humidity and temperature of the environment, the screws may need to be tightened during the driest winter months.

