

ASSEMBLY DESCRIPTION

nola

Head office: Nola Industrier AB Repslagargatan 15b Box 17701
 S-118 93 Stockholm T:+46(0)8 702 19 60 F:+46(0)8 702 19 62
 E:headoffice@nola.se Sales/showroom: Skeppsbron 3
 S-211 20 Malmö T:+46(0)40 17 11 90 Order fax:+46(0)40 12 75 45

www.nola.se

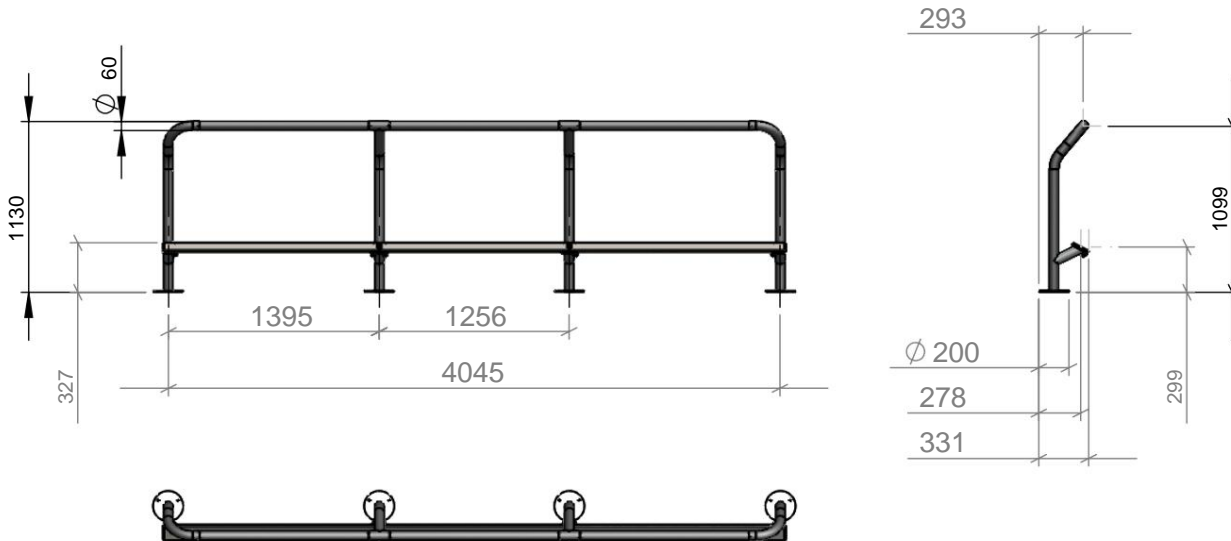
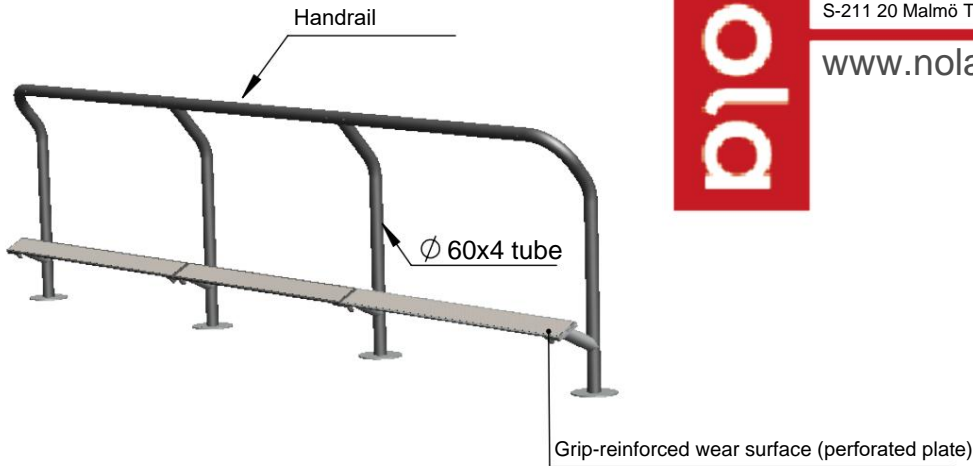

U02-95 + U02-96

Specification /

U02-95 Base section
U02-96 Extension section

Delivery specification /

U02-95 Base section
 1st U02-95-2-1 Post right
 1st U02-95-2-3 Post left
 1st U02-95-2-2 Pole center
 2 pcs U02-95-2-4 Handrail
 2 pcs U02-95-2-8 Foot plate
 1st Set with screw
U02-96 Extensionssection
 1 pc U02-95-2-2 Pole center
 1 pc U02-95-2-4 Handrail
 1 pc U02-95-2-9 Foot plate
 1pc Set with screw

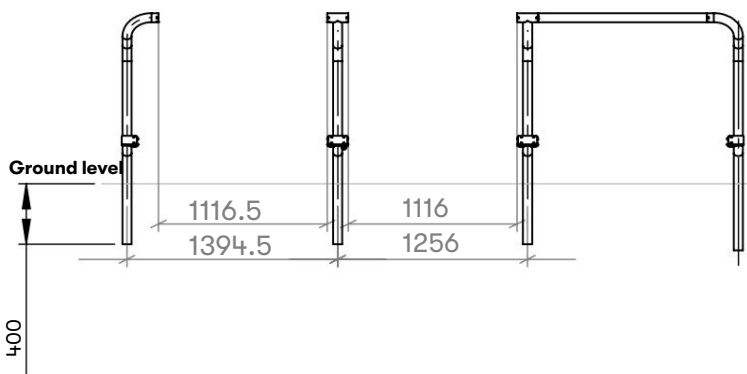

Installation of poles /

There are two variants of Darkrail. One with drop-in posts and a variant with a foot plate for ground mounting.

For mounting with cast-in post /

A hole is dug in the ground to a frost-free depth. Set down a molded cardboard tube with a diameter of 150mm. The length of the cardboard tube must be adjusted so that it ends approx. 50 mm below the ground surface. Put down a couple of rebars that are cut off a couple of cm below the ground surface.

Also prepare for wiring. Fill the pipe with concrete. Place the bollard in the casting pipe. The post must go down 400 mm below the ground. Brace them vertically and laterally. Let the concrete cure.

Remove the bracing and backfill the soil around the post.

It is also possible to use prefabricated foundations for 60 mm pipes with extended post.

To mount footplate a to the ground /

Set up the bollard temporarily. Mark the holes on the ground. Drill holes for suitable fasteners. The hole is 15mm and intended for attachment with chemical anchor or expander M12. Do not use the bollard as a drill template!

Installation on a wooden substrate /

Mount with wood screws on the substrate.

Installation on small streets or street tiles /

Undercast the slabs with concrete. There must not be any setting sand between the tiles and the concrete. Drill the plate for expanders or chemical anchors. Mounting with an expander provides a removable attachment. Installation with chemical anchors provides a permanent attachment.

Installation on concrete base /

Drill the concrete for expanders or chemical anchors. Mounting with an expander provides a removable attachment. Installation with chemical anchors provides a permanent attachment.

Installation on gravel or grass /

Excavate ground for a concrete foundation. Cast a foundation in concrete pipe or cardboard pipe. Cast in a flex tube for cable routing.

The top of the foundation must end with a radius. Drill the foundation for expanders or chemical anchors. Install fixed foot against foundation.

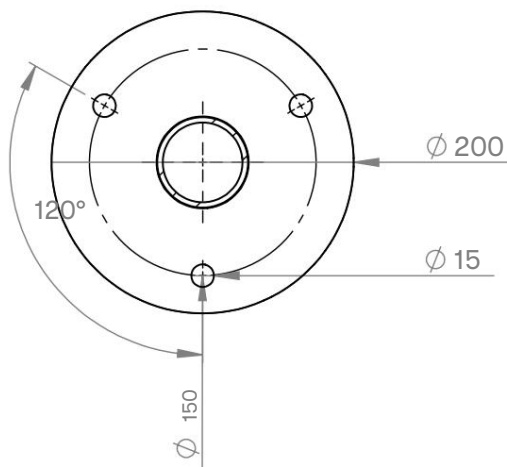
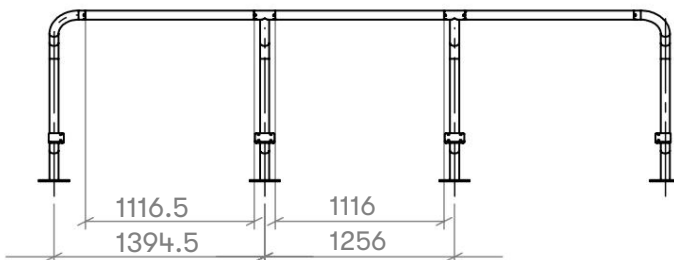



Assembly of handrails /

The hand guide is provided with a threaded tin at the ends, there are recesses on the underside of the post to insert the pipe. When the tube is in place, it is turned 90 and the handguard ° is locked with countersunk M4 from the outside.

Installation of footrests /

Foot plate for middle section and outer section look different but are mounted in the same way.

1) Foot plate is provided with 4 welding bolts on the underside. These fit into the corresponding holes in the mounting ears of the posts.

See picture.

2) Screw in the welding bolt with the associated clamping washer and dome nut.

