

# Kebne 4<sub>p.1/7</sub>

## ASSEMBLY INSTRUCTIONS



Head office: Nola Industrier AB Box 17701 Repslagargatan 15b  
118 93 Stockholm Tel: 08 702 1960 Fax: 08 702 1962 [headoffice@nola.se](mailto:headoffice@nola.se)  
Customer services/showroom/export/press: Skeppsbron 3 211 20 Malmö  
Tel: 040171 190 Orderfax: 040 127 545 [order@nola.se](mailto:order@nola.se)

[www.nola.se](http://www.nola.se)

## OVERVIEW

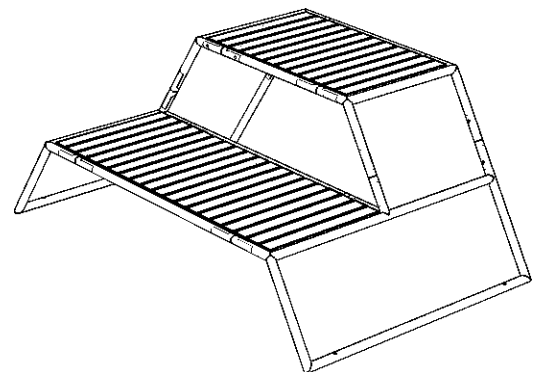
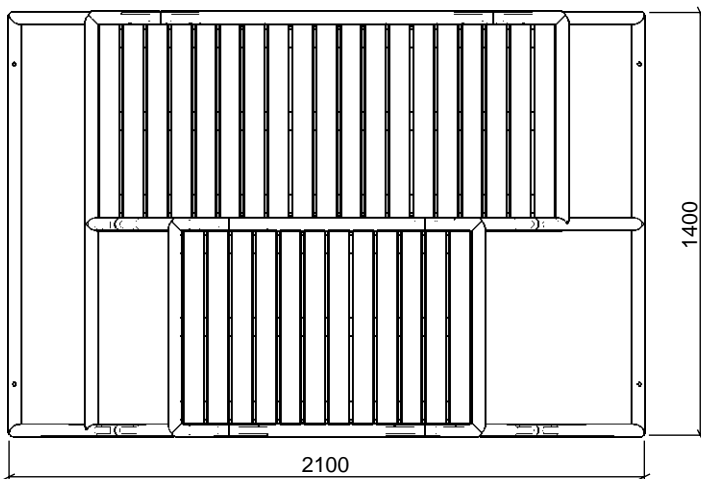
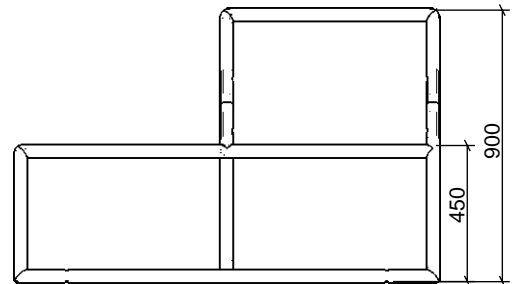
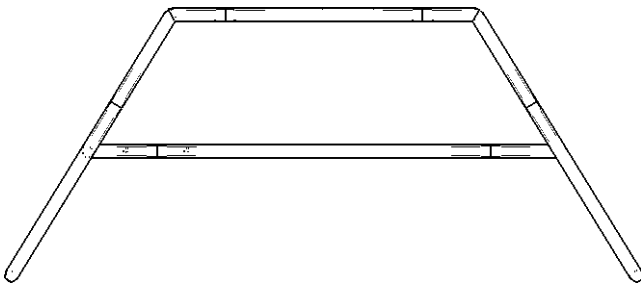

Kebne 1 product number Ö72-13

# Kebne 4<sub>p.2/7</sub>

## ASSEMBLY INSTRUCTIONS



Head office: Nola Industrier AB Box 17701 Repslagargatan 15b  
118 93 Stockholm Tel: 08 702 1960 Fax: 08 702 1962 [headoffice@nola.se](mailto:headoffice@nola.se)  
Customer services/showroom/export/press: Skeppsbron 3 211 20 Malmö  
Tel: 040171 190 Orderfax: 040 127 545 [order@nola.se](mailto:order@nola.se)

[www.nola.se](http://www.nola.se)

## PARTS INCLUDED

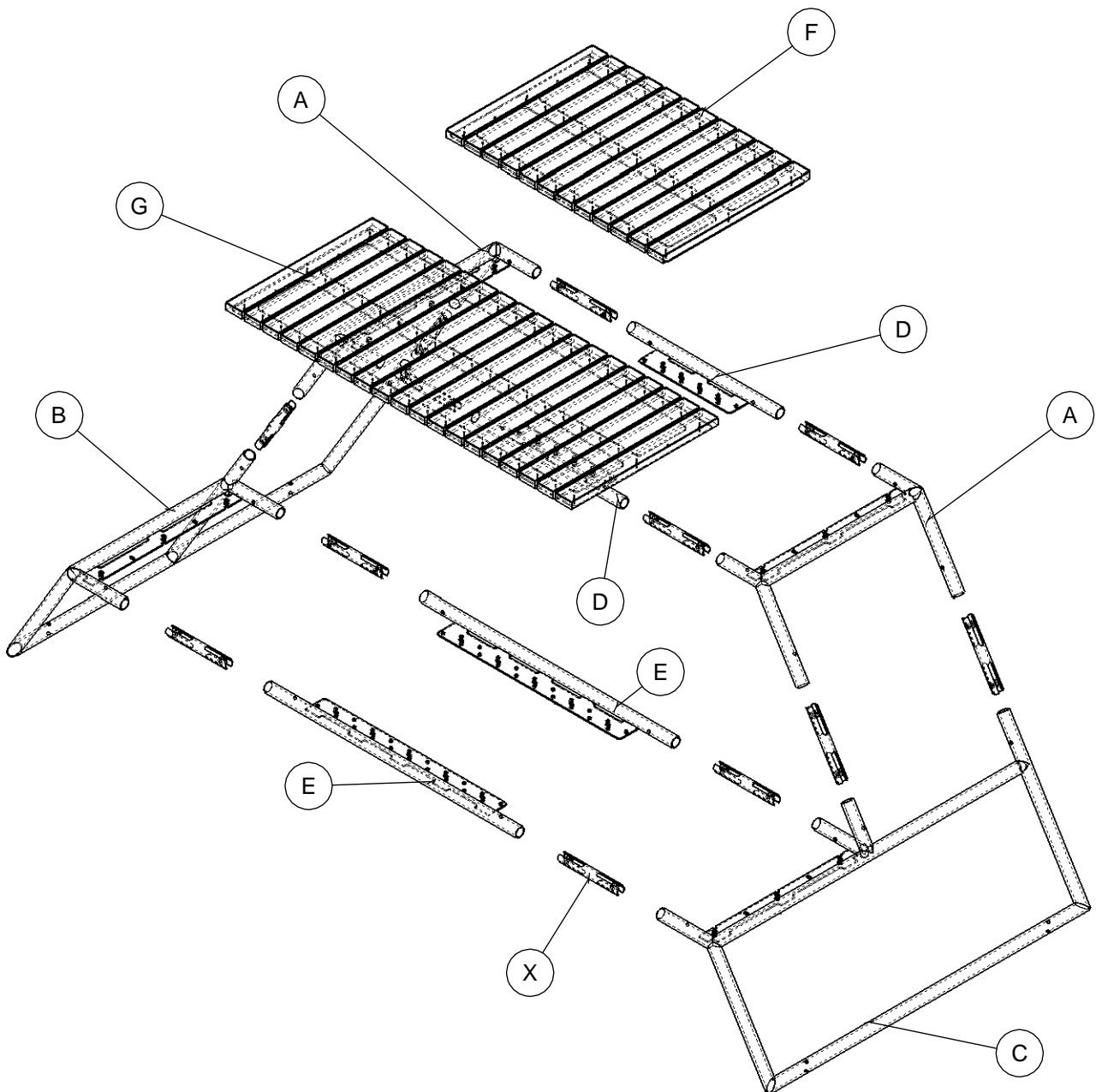

# Kebne 4<sub>p.3/ 7</sub>

## ASSEMBLY INSTRUCTIONS



Head office: Nola Industrier AB Box 17701 Repslagargatan 15b  
118 93 Stockholm Tel: 08 702 1960 Fax: 08 702 1962 headoffice@nola.se  
Customer services/showroom/export/press: Skeppsbron 3 211 20 Malmö  
T: 040171 190 Orderfax: 040 127 545 order@nola.se

www.nola.se

## PARTS INCLUDED

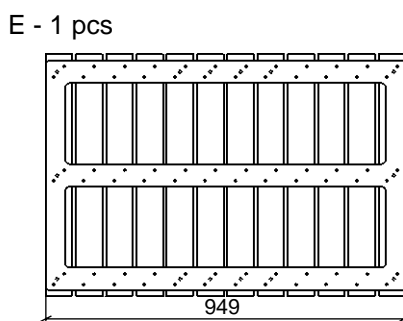
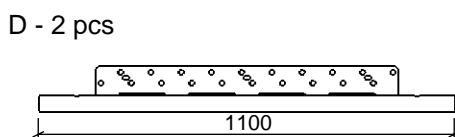
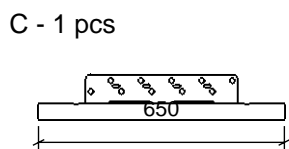
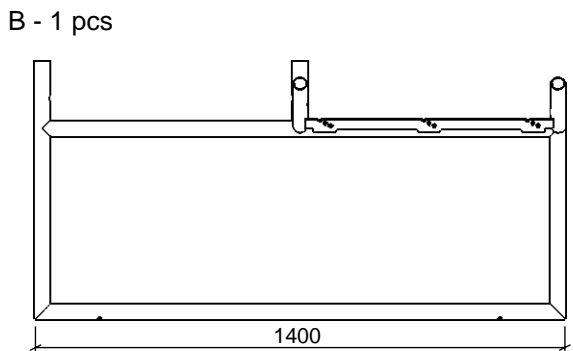
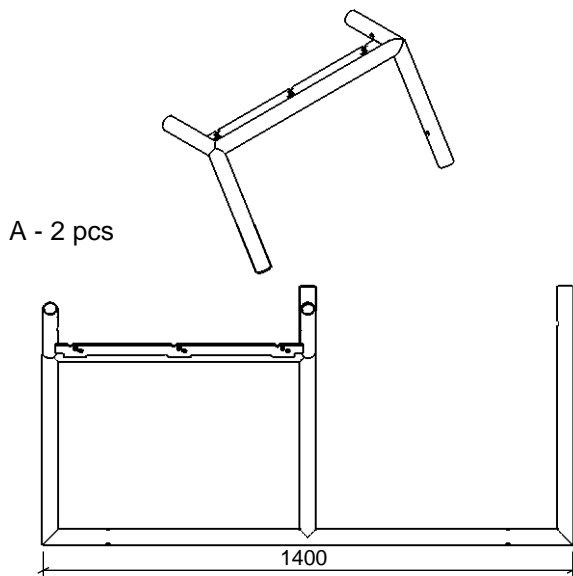

F - 1 pcs

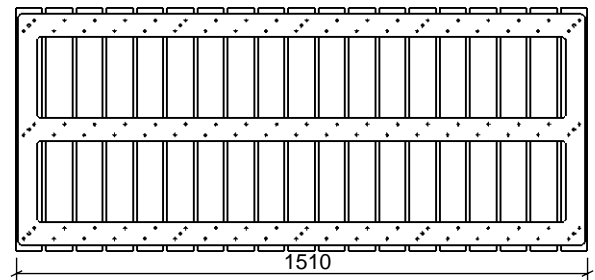

G - 1 pcs

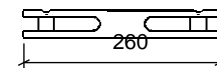

X - 12 pcs

### For mounting

Stop screw M10x30 - 24

pcs K6S M10x30 - 4 pcs

Washers for M10 4 pcs

M8x10 (for attaching timber) - 25 pcs

Trays for M8 - 25 pcs

For attaching 20 cm below ground level

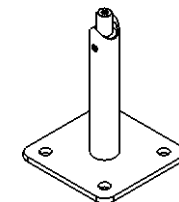

Y - 4 pcs

For attaching to the ground



Z - 4 pcs

Kebne 1 product number Ö72-13

## ASSEMBLY INSTRUCTIONS



Head office: Nola Industrier AB Box 17701 Repslagargatan 15b  
118 93 Stockholm Tel: 08 702 1960 Fax: 08 702 1962 headoffice@nola.se  
Customer services/showroom/export/press: Skeppsbron 3 211 20 Malmö  
T: 040171 190 Orderfax: 040 127 545 order@nola.se

[www.nola.se](http://www.nola.se)

## ASSEMBLY

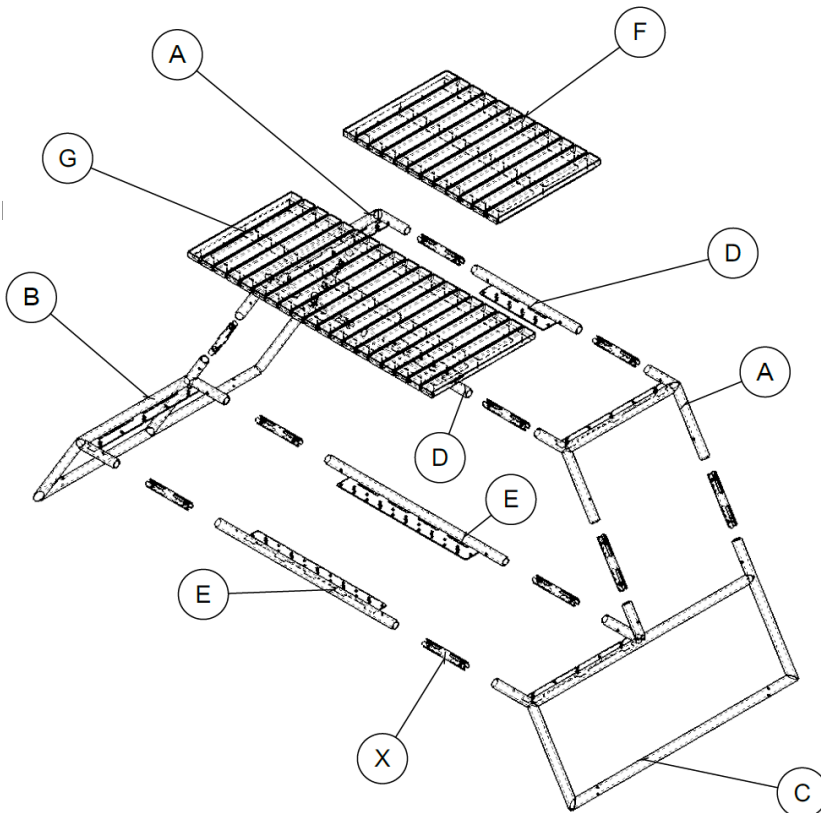

1. Assemble the end plates AB + AC with connecting fitting X. See the principle for mounting.
2. Screw on connecting fittings (without tightening them) in all openings on D + E
3. Assemble the end panels with DD + EE at the same time. Tighten all screws according to the following principle.
4. Attach the timber modules F + G and fasten with M8X10 + washer (a total of 25 screws)

## PRINCIPLE FOR ASSEMBLY

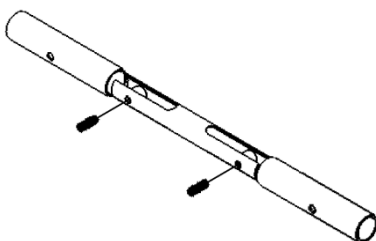

1. A connecting fitting (X) and two stop screws M10x30 are needed for each join.

PLEASE NOTE! THE SCREWS MUST BE LUBRICATED!

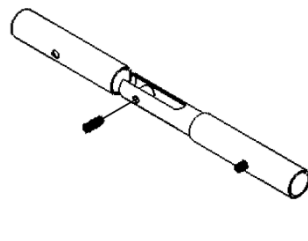

2. Screw the connecting fitting into one part without tightening the screw.

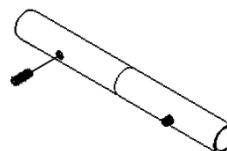

3. Join the parts and screw in the other screw.

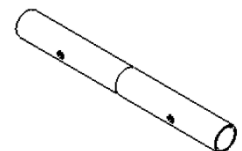

4. Ensure that the two parts are lined up and then tighten the screws alternately until the screw head is in line with the outer tube. Be careful not to pull so hard that the outer tube is deformed.

## ASSEMBLY INSTRUCTIONS



Head office: Nola Industrier AB Box 17701 Repslagargatan 15b  
118 93 Stockholm Tel: 08 702 1960 Fax: 08 702 1962 headoffice@nola.se  
Customer services/showroom/export/press: Skeppsbron 3 211 20 Malmö  
T: 040171 190 Orderfax: 040 127 545 order@nola.se

www.nola.se

## ATTACHMENT 20 CM BELOW GROUND LEVEL

Install the mounting brackets with washer + K6S M10 x 30 (supplied). Fully tighten the screw. The pipe should be flattened slightly against the mounting bracket.

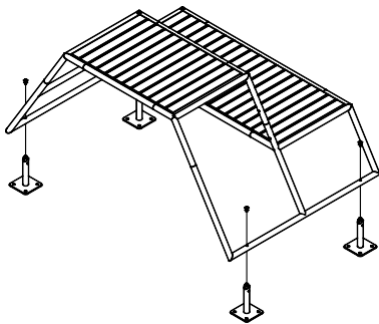

The mounting brackets have a base plate with four holes for mounting with M16 bolt.

Dig to frost-free depth and base with a non-frosting material. Use prefab foundation or cast concrete foundation on site. Drill holes in the foundation and mount with core anchor/expander.

Fill with 20 cm of shock absorbing surface. For example, Bark/gravel/sand

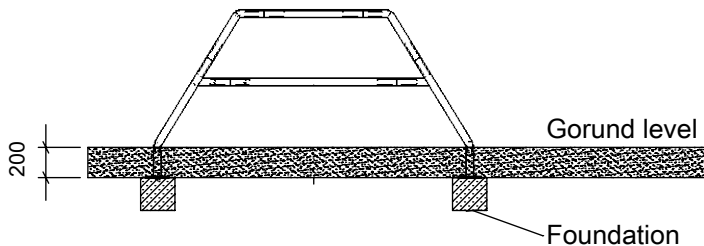

Shock-absorbing safty material

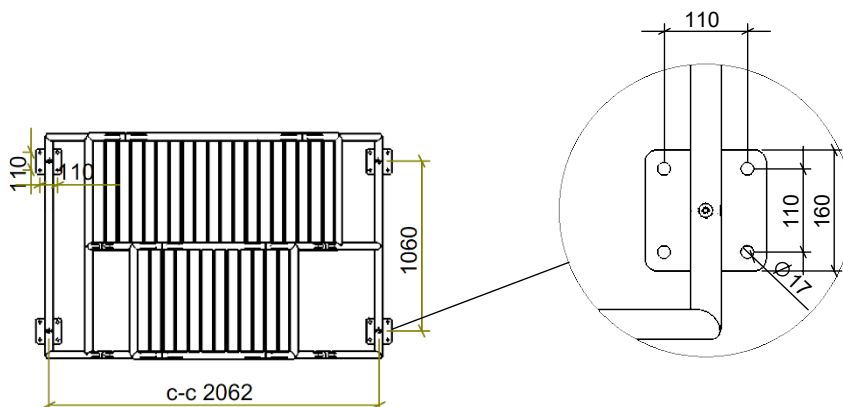

## ASSEMBLY INSTRUCTIONS



Head office: Nola Industrier AB Box 17701 Repslagargatan 15b  
118 93 Stockholm Tel: 08 702 1960 Fax: 08 702 1962 headoffice@nola.se  
Customer services/showroom/export/press: Skeppsbron 3 211 20 Malmö  
T: 040171 190 Orderfax: 040 127 545 order@nola.se

[www.nola.se](http://www.nola.se)

## ATTACHING TO THE GROUND

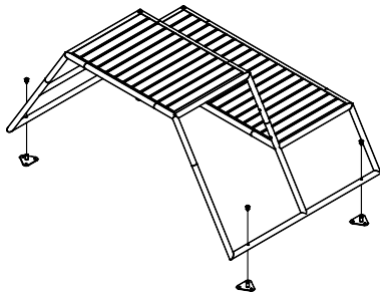

Install the mounting brackets with washer + K6S M10 x 30 (supplied). Fully tighten the screw. The pipe should be flattened slightly against the mounting bracket.

The mounting brackets have a base plate with four holes for mounting with M10 bolt.

Drill holes in the foundation and mount with core anchor/expander.

Mounting on wooden base using French wood screw.

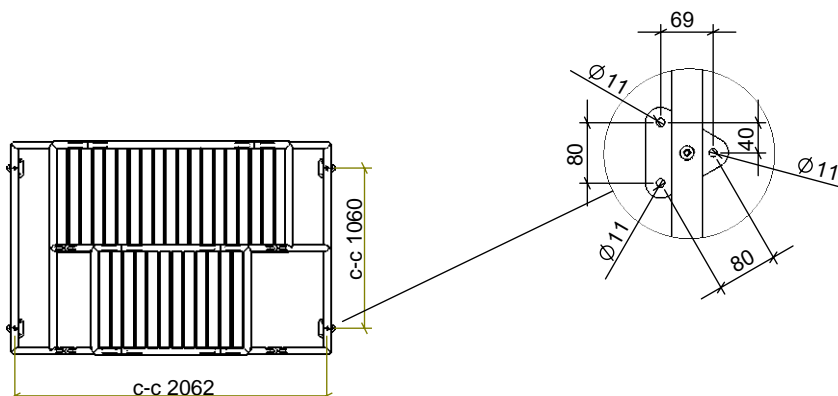
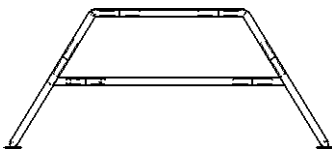

## ASSEMBLY INSTRUCTIONS



Head office: Nola Industrier AB Box 17701 Repslagargatan 15b  
118 93 Stockholm Tel: 08 702 1960 Fax: 08 702 1962 headoffice@nola.se  
Customer services/showroom/export/press: Skeppsbron 3 211 20 Malmö  
T: 040171 190 Orderfax: 040 127 545 order@nola.se

[www.nola.se](http://www.nola.se)

## SAFETY DISTANCE/FALL PROTECTION

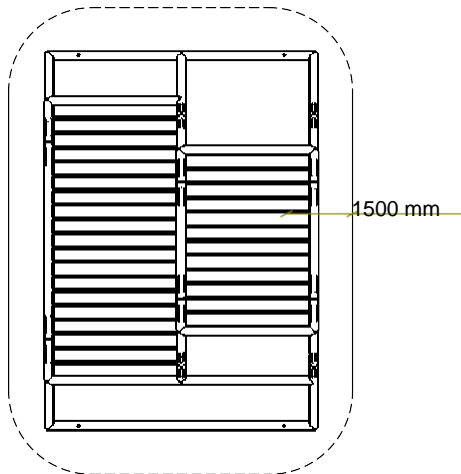

Nola recommends a safety distance of 1.5 m from the outer edge of each unit. Note that the recommended distance between two units then adds up to 3 m.

Nola also recommends that fall protection is installed according to Swedish standard SS-EN 16630:2015 "Permanently installed fitness equipment for outdoor use - Safety requirements and test methods".

Examples of fall protection can be 20 cm sand, gravel or bark. A substratum of rubber granules or grass may also act as fall protection.

